

Miscellaneous Options

Some grinding applications are able to utilize the standard system configuration and the options offered in this catalog up to this point. Most applications, since all are unique, inevitably will require additional special options. Shown on this page are various options that have been supplied in the past.

Extension Cable – This cable provides an extension between the bulkhead connector from the control panel or electrical enclosure and the spindle electrical connector.

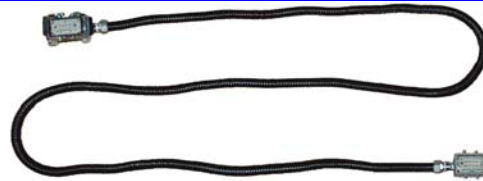

Adapter Brackets – G II Solutions have developed numerous brackets for various grinder / spindle combinations. Oftentimes the more popular are in stock.



Diamond Rolls – Generally, G II Solutions will have some basic shaped diamond rolls in stock. If a particular style is not in stock, G II Solutions is equipped to lead to customer in the right direction.

Adapter Brackets – Most applications require a bracket to mount the spindle to the grinding machine. G II Solutions have developed various brackets for different spindle / grinder combinations. Often, G II Solutions will have the more popular combinations in stock. In any case, G II Solutions will work with the customer to identify, engineer, and if desired, manufacture the best solution.

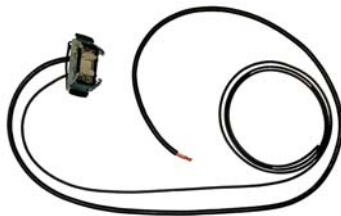

Interface Cable – This cable may be used as an interface between the external inputs and outputs of the control system and the interfacing machine's CNC and power.

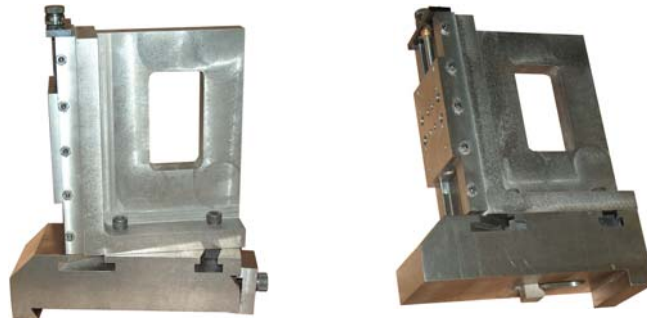

G II Solutions, Inc.
201 Bank Street
P.O. Box 428
Central, SC 29630

Phone: 864.639.6605
Fax: 864.639.4056
E-mail: info@giisolutions.com
Web Site: www.giisolutions.com