

## CONTROL PACKAGE

# Standard Configuration

The standard DTS system control package features an open panel with a set of pre-wired components. With this configuration, the control panel is intended to be mounted in the interfacing machine's existing electrical enclosure. Cable exits the control panel and terminates at a bulkhead connector that generally mounted in the wall of the existing enclosure. The control package features a servo amplifier that requires a single or three phase, AC power source ranging from 90-270 volts. Also featured are a set of manual controls and an interface module for PLC or CNC interface. Additional configurations are available upon request.

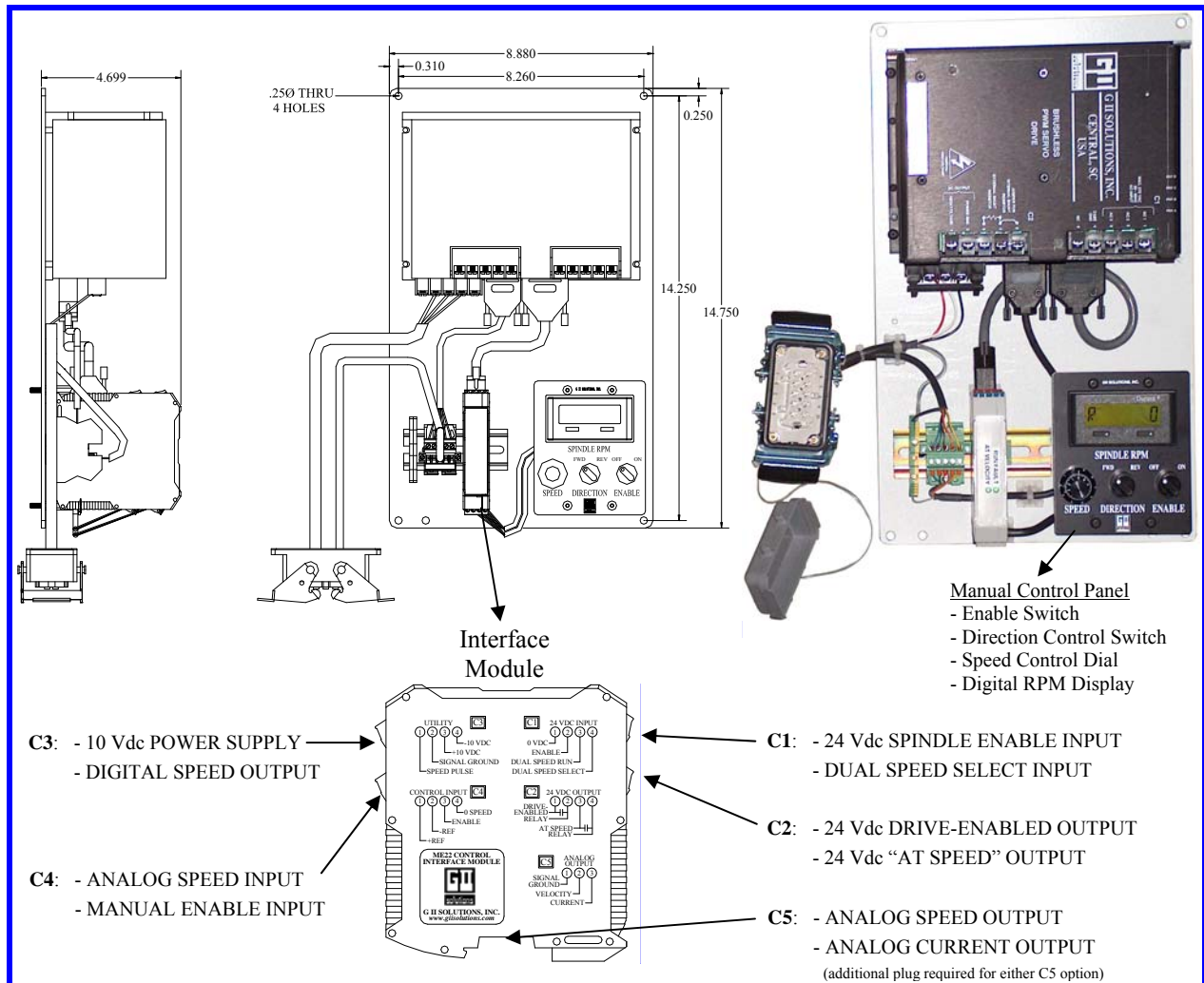

**G II Solutions, Inc.**  
201 Bank Street  
P.O. Box 428  
Central, SC 29630

Phone: 864.639.6605  
Fax: 864.639.4056  
E-mail: info@giisolutions.com  
Web Site: www.giisolutions.com